

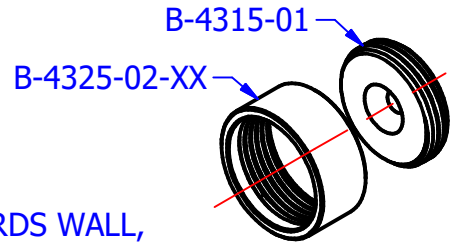

Technical Data Sheet

B-4365-XX

Ø1¼" SHOWER ROD CONCEALED MOUNT



SLIDE BOTH COLLARS ON TO ROD WITH THREADS TOWARDS WALL, POSITION ROD BETWEEN WALL PLATES, THREAD COLLARS TO WALL PLATE.

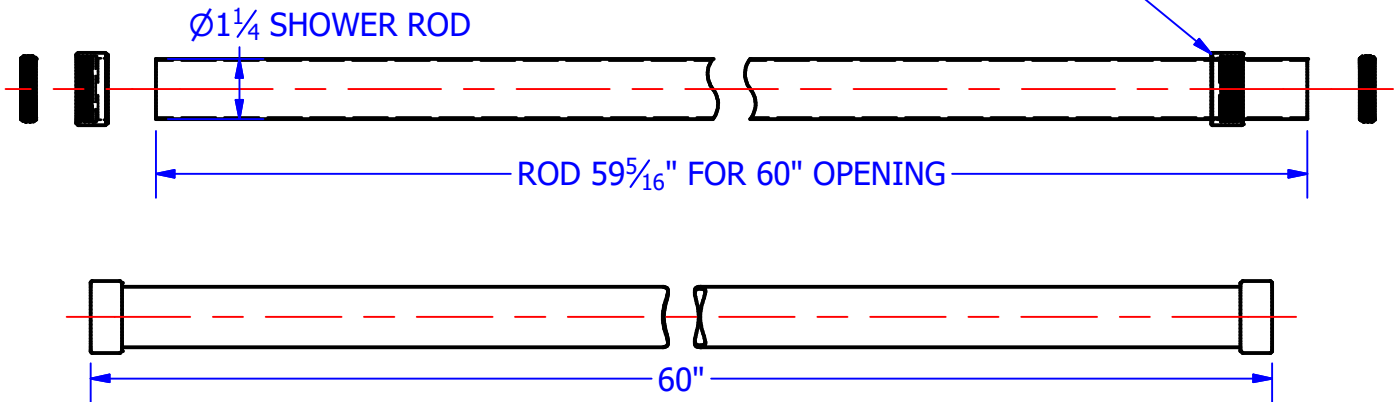

CONSTRUCTION:

- MOUNTING PLATE: THREADED SOLID BRASS WITH A Ø1¼" HOLE FOR MOUNTING TO WALL.
- COLLAR FLANGE : BRASS TUBE, THREADED TO ENGAGE MOUNTING PLATE, PLATED OR POWDER COATED TO SUIT.

INSTALLATION:

1. MARK AND INSTALL THE (2) B-4315-01 THREADED WALL PLATES USING THE MOUNTING HOLE PROVIDED, ONE ON EACH WALL. #10, #12 or ¼" SCREWS MAY BE USED FOR MOUNTING.
2. MAKE SURE THAT THE MOUNTING PLATES ARE THE SAME DISTANCE FROM THE CEILING AND IN LINE.
3. YOUR SHOWER ROD LENGTH SHOULD BE THE WALL TO WALL DISTANCE MINUS 5/8" EXAMPLE; TO PROPERLY FIT A 60" OPENING REQUIRES A SHOWER ROD LENGTH OF 59 5/16" to 59 3/8".
4. PLACE THE ROD BETWEEN THE TWO WALL PLATES AND THREAD EACH COLLAR FLANGE TIGHT TO THE WALL.

GUIDE SPECIFICATION:

- ALL BRASS CONSTRUCTION
- HOLDS A Ø1¼" SHOWER ROD (NOT SUPPLIED)
- A CEILING SUPPORT MAY BE REQUIRED ON LONGER SPANS.
- WALL FASTENERS ARE NOT INCLUDED.

FINISH TAB CHART	
PART NUMBER	FINISH
B-4365-BB	BRIGHT BRASS
B-4365-BC	BRIGHT CHROME
B-4365-SC	SATIN CHROME
B-4365-SN	SATIN NICKEL
B-4365-SB	SATIN BRASS
B-4365-PC	POWDER COAT
	(SPECIFY COLOR)

Brey-Krause Mfg. reserves the right to make changes in design and/or material without formal notice and without incurring any obligation.

**BREY-KRAUSE
MANUFACTURING**

© 2013

BREY-KRAUSE MANUFACTURING
1209 W. Lehigh Street, Bethlehem, PA 18018
Phone: 610-867-1401 Fax: 610-866-1433
www.brey-krause.com